

FIXING IN ACCORDANCE WITH THE MANUFACTURERS
PRINTED INSTRUCTIONS, BS5534 PART 1 2014,
BS8000 PART 6 2013 AND H62/210 AND 275

UNDER-EAVES BATTEN
UNDEREAVES SLATE COURSE
LENGTH = GAUGE + LAP,
HEAD NAILED TO EAVES BATTEN

EAVES VENTILATION

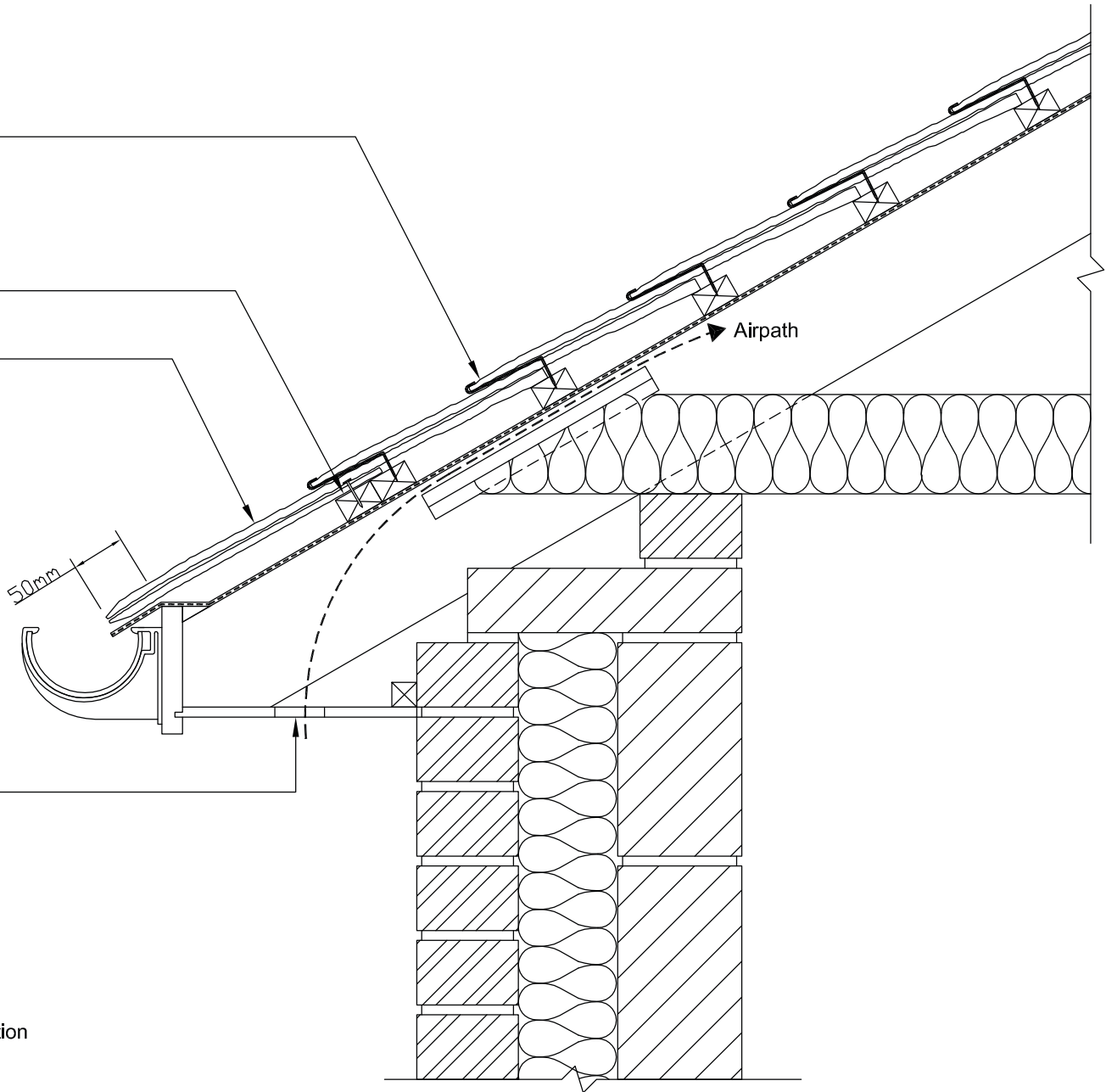

1. Fix the underlay to extend over the tilting fillet and fascia board into the gutter. The underlay should overhang the fascia board by 50mm.
2. Fix the first full course batten (the eaves batten) so that the tails of the slates in the eaves and the undereaves courses align, ensuring that they will overhang 50 to 60mm into the gutter. Fix an undereaves batten below the eaves batten at a position which corresponds with the hook length from the tail of the eaves course slates.
3. Lay the slates forming the undercourse on their backs and head-nail them to the eaves batten.
4. Fix the eaves course with the tails of the slates aligning with the tails of slates in the undereaves course.
5. Commence hook fixing on second course of slates.

SSQ NATURAL SLATE
TYPICAL EAVES DETAIL
500X250 DEL CARMEN, ULTRA GRADE (NATURAL SLATE)
DRG 014